



**DEPARTMENT OF THE ARMY**  
 NEW ENGLAND DISTRICT, CORPS OF ENGINEERS  
 696 VIRGINIA ROAD  
 CONCORD, MASSACHUSETTS 01742-2751

REPLY TO  
ATTENTION OF

**MAINE PROGRAMMATIC GENERAL PERMIT (PGP)  
 AUTHORIZATION LETTER AND SCREENING SUMMARY**

MAINE MOUNTAIN POWER, LLC  
 C/O WOODLOT ALTERNATIVES, INC.  
 30 PARK DRIVE  
 TOPSHAM, MAINE 04086

CORPS PERMIT # NAE-2006-2117  
 CORPS PGP ID# 06-334  
 STATE ID# LURC ZP-702

**DESCRIPTION OF WORK:**

Fill approximately 0.09 acres of freshwater wetland adjacent to unnamed streams at Reddington and Wyman Townships and Carrabasset Valley, Maine in order to develop a 90 megawatt mountaintop wind generating facility including 30 turbines, electrical transmission lines, a maintenance building, and access roadways. Approximately 0.06 acres of the fill will be temporary and the remaining 0.03 acres will be permanent.

LAT/LONG COORDINATES : 45.0317867° N 70.4473987° W USGS QUAD: BLACK NUBBLE, ME

**I. CORPS DETERMINATION:**

Based on our review of the information you provided, we have determined that your project will have only minimal individual and cumulative impacts on waters and wetlands of the United States. **Your work is therefore authorized by the U.S. Army Corps of Engineers under the enclosed Federal Permit, the Maine Programmatic General Permit (PGP).**

You must perform the activity authorized herein in compliance with all the terms and conditions of the PGP [including any attached Additional Conditions and any conditions placed on the State 401 Water Quality Certification including any required mitigation]. Please review the enclosed PGP carefully, including the PGP conditions beginning on page 7, to familiarize yourself with its contents. You are responsible for complying with all of the PGP requirements; therefore you should be certain that whoever does the work fully understands all of the conditions. You may wish to discuss the conditions of this authorization with your contractor to ensure the contractor can accomplish the work in a manner that conforms to all requirements.

If you change the plans or construction methods for work within our jurisdiction, please contact us immediately to discuss modification of this authorization. This office must approve any changes before you undertake them.

Condition 38 of the PGP (page 15) provides one year for completion of work that has commenced or is under contract to commence prior to the expiration of the PGP on October 11, 2010. You will need to apply for reauthorization for any work within Corps jurisdiction that is not completed by October 11, 2011.

No work may be started unless and until all other required local, State and Federal licenses and permits have been obtained. **This includes but is not limited to a Flood Hazard Development Permit issued by the town if necessary.** Also, this permit requires you to notify us before beginning work and allow us to inspect the project. Hence, you must complete and return the attached Work Start Notification Form(s) to this office no later than 2 weeks before the anticipated starting date. (For projects requiring mitigation, be sure to include the MITIGATION WORK START FORM).

**II. STATE ACTIONS: PENDING [ X ] ISSUED [ ] DENIED [ ] DATE \_\_\_\_\_**

APPLICATION TYPE: PBR: \_\_\_\_\_ TIER 1: \_\_\_\_\_ TIER 2: \_\_\_\_\_ TIER 3: X LURC: X DMR LEASE: \_\_\_\_\_ NA: \_\_\_\_\_

**III. FEDERAL ACTIONS:**

JOINT PROCESSING MEETING: 6/22/06 LEVEL OF REVIEW: CATEGORY 1: \_\_\_\_\_ CATEGORY 2: X

AUTHORITY: SEC 10 \_\_\_\_\_, 404 X 10/404 \_\_\_\_\_, 103 \_\_\_\_\_

EXCLUSIONS: The exclusionary criteria identified in the general permit do not apply to this project.

**ESSENTIAL FISH HABITAT (EFH): EFH PRESENT Y (N) (CIRCLE ONE)**

IF YES: Based on the terms and conditions of the PGP, which are intended to ensure that authorized projects cause no more than minimal environmental impacts, the Corps of Engineers has preliminary determined that this project will not cause more than minimal adverse effects to **EFH** identified under the Magnuson-Stevens Fisheries Conservation and Management Act.

**FEDERAL RESOURCE AGENCY OBJECTIONS: EPA NO \_\_\_\_\_, USF&WS NO \_\_\_\_\_, NMFS NO \_\_\_\_\_**

If you have any questions on this matter, please contact my staff at 207-623-8367 at our Manchester, Maine Project Office.

*Jay L. Clement*  
 JAY L. CLEMENT  
 SENIOR PROJECT MANAGER  
 MAINE PROJECT OFFICE

*Frank J. Del Giudice* 1 MAY 2007  
 FRANK J. DEL GIUDICE DATE  
 CHIEF, PERMITS & ENFORCEMENT BRANCH  
 REGULATORY DIVISION



**US Army Corps  
of Engineers** ®  
New England District

**ADDITIONAL CONDITIONS FOR  
DEPARTMENT OF THE ARMY  
PROGRAMMATIC GENERAL PERMIT  
NO. NAE-2006-2117**

1. The permittee shall assure that a copy of this permit is at the work site whenever work is being performed and that all personnel performing work at the site of the work authorized by this permit are fully aware of the terms and conditions of the permit. This permit, including its drawings and any appendices and other attachments, shall be made a part of any and all contracts and sub-contracts for work which affects areas of Corps of Engineers' jurisdiction at the site of the work authorized by this permit. This shall be done by including the entire permit in the specifications for the work. If the permit is issued after construction specifications but before receipt of bids or quotes, the entire permit shall be included as an addendum to the specifications. The term "entire permit" includes permit amendments. Although the permittee may assign various aspects of the work to different contractors or sub-contractors, all contractors and sub-contractors shall be obligated by contract to comply with all environmental protection provisions of the entire permit, and no contract or sub-contract shall require or allow unauthorized work in areas of Corps of Engineers jurisdiction.
2. Adequate sedimentation and erosion control devices, such as geotextile silt fences or other devices capable of filtering the fines involved, shall be installed and properly maintained to minimize impacts during construction. These devices must be removed upon completion of work and stabilization of disturbed areas. The sediment collected by these devices must also be removed and placed upland, in a manner that will prevent its later erosion and transport to a waterway or wetland.
3. All exposed soils resulting from the construction will be promptly seeded and mulched in order to achieve vegetative stabilization.
4. The permittee must still obtain any other Federal, State, or local permits as required by law before beginning work. This includes but is not limited to a Flood Hazard Development Permit issued by the town if necessary.
5. All areas of temporary waterway or wetland fill will be restored to their original contour and character upon completion of the project.
6. No additional filling of waters of the United States (wetlands or waterways) is authorized without written approval from the Corps.

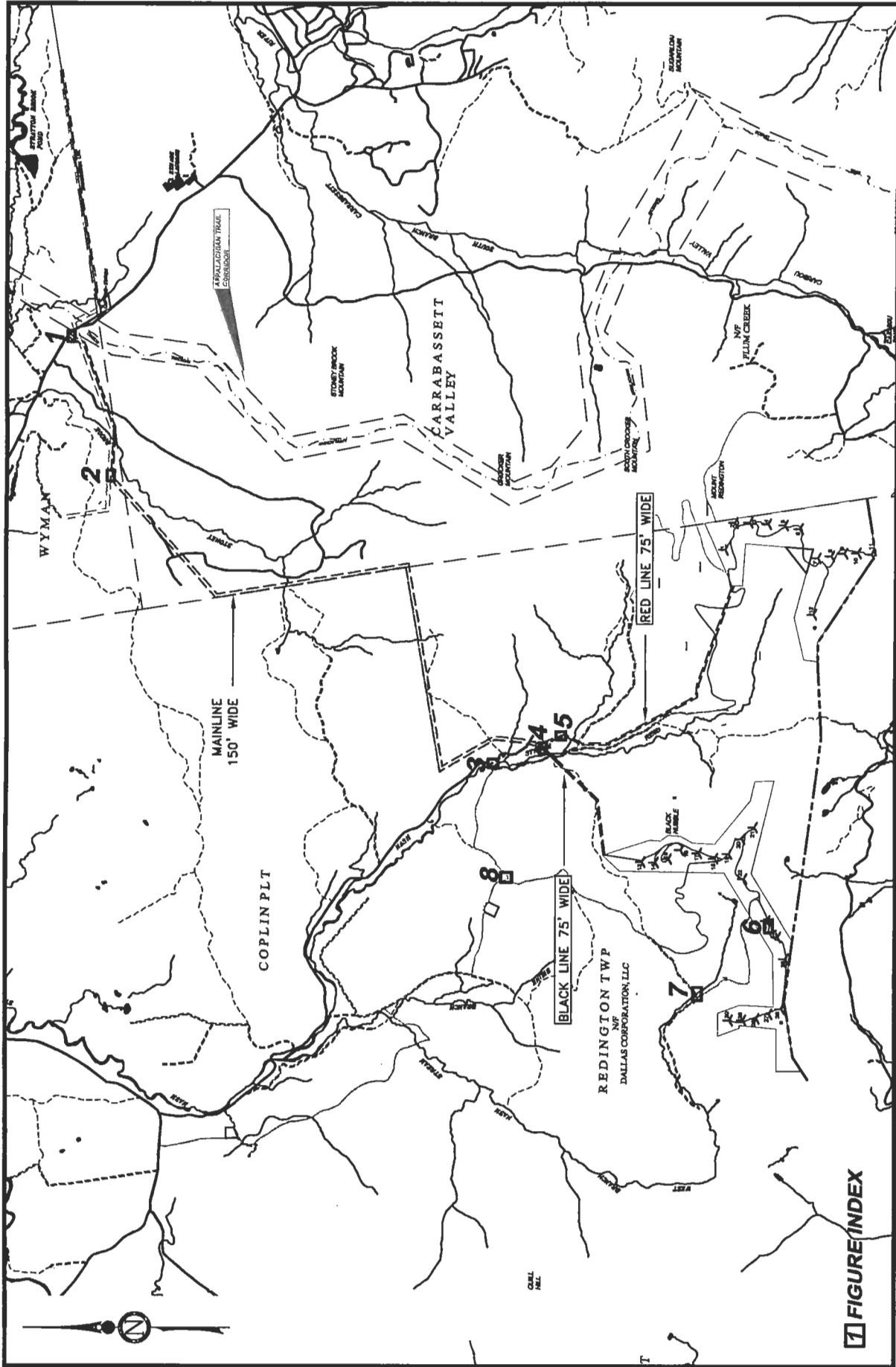

<p>FIGURE: <b>KEY</b></p>	
<p>SHEET TITLE: <b>Attachment 1 Key Map</b></p>	
<p>PROJECT: <b>Maine Mountain Power, LLC Proposed Redington Wind Farm</b></p>	
DESIGN:	DATE: December 2006
DRAFT:	PROJ. NO.: 102127
CHECKED:	SCALE: NA
<p>FILE: 102127-F000-key.dwg</p>	
<p>PREPARED BY: <b>WOODLOT ALTERNATIVES, INC. ENVIRONMENTAL CONSULTANTS</b></p>	

**LEGEND**

WETLAND IDENTIFIED BY WOODLOT ALTERNATIVES

WETLAND AND STREAM IDENTIFIER

STREAMS LOCATED BY WOODLOT ALTERNATIVES

PROPOSED TRANSMISSION LINE CORRIDOR

PROPOSED TRANSMISSION POLE LOCATION

**NOTES:**

1. THIS MAP IS TO BE USED FOR ILLUSTRATION PURPOSES ONLY.

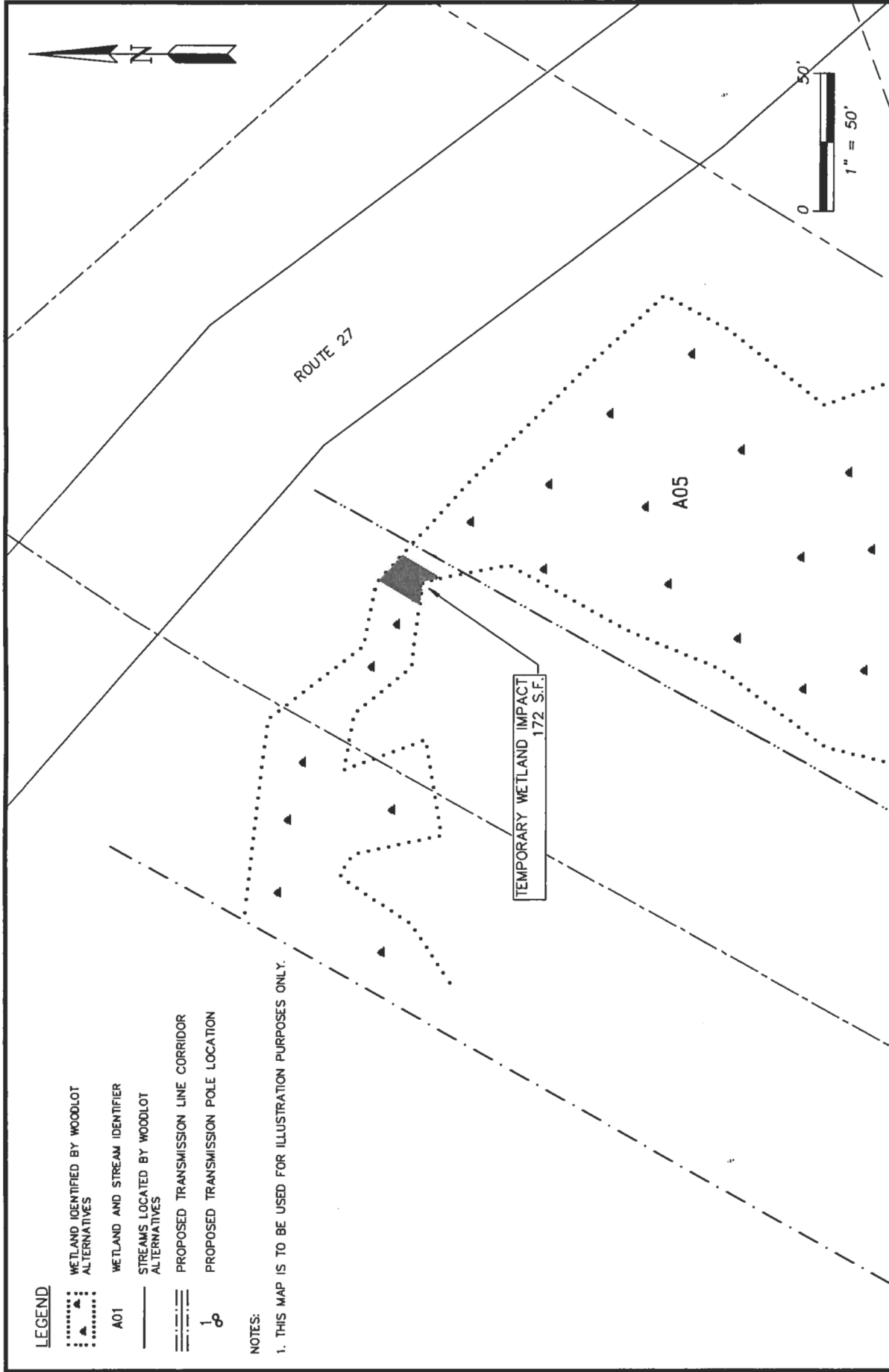

PREPARED BY:



DESIGN:	DATE: December 2006
DRAFT:	PROJ. NO.: 102127
CHECKED:	SCALE: 1" = 50'
FILE: 102127-F000-ACOE-impacts.dwg	

SHEET TITLE:

Temporary Impacts  
Wetland A05  
Maine Mountain Power, LLC  
Proposed Redington Wind Farm

FIGURE:

1 of 8

**LEGEND**

WETLAND IDENTIFIED BY WOODLOT ALTERNATIVES

WETLAND AND STREAM IDENTIFIER  
A01

STREAMS LOCATED BY WOODLOT ALTERNATIVES  
PROPOSED TRANSMISSION LINE CORRIDOR  
PROPOSED TRANSMISSION POLE LOCATION

**NOTES:**

1. THIS MAP IS TO BE USED FOR ILLUSTRATION PURPOSES ONLY.

EXISTING BORALEX CORRIDOR

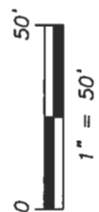
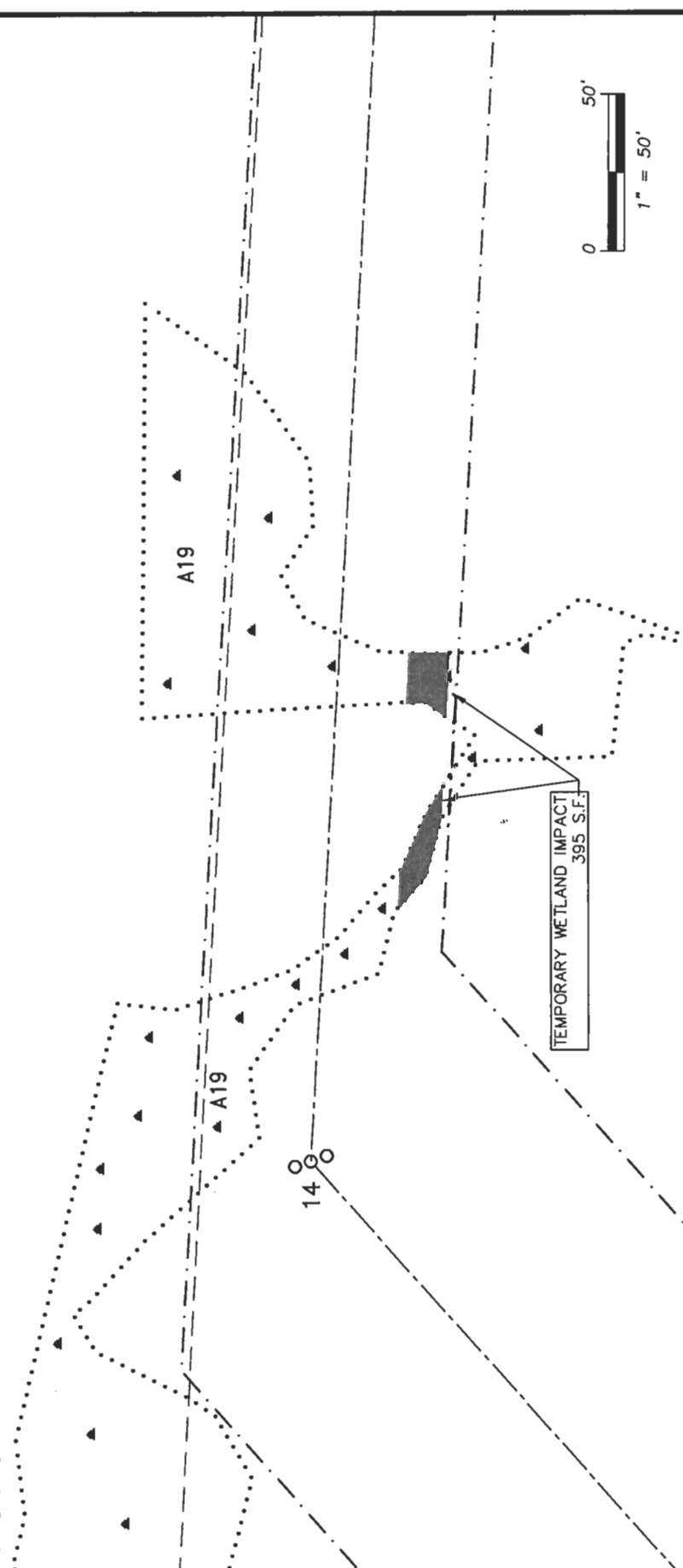

FIGURE:  
**2 of 8**

SHEET TITLE:  
**Temporary Impacts  
Wetland A19**

PROJECT:  
Maine Mountain Power, LLC  
Proposed Redington Wind Farm

DESIGN:	DATE: December 2006
DRAFT:	PROJ. NO.: 102127
CHECKED:	SCALE: 1" = 50'
FILE: 102127-F000-ACOE-impacts.dwg	

PREPARED BY:

**WOODLOT**  
ALTERNATIVES, INC.  
ENVIRONMENTAL CONSULTANTS

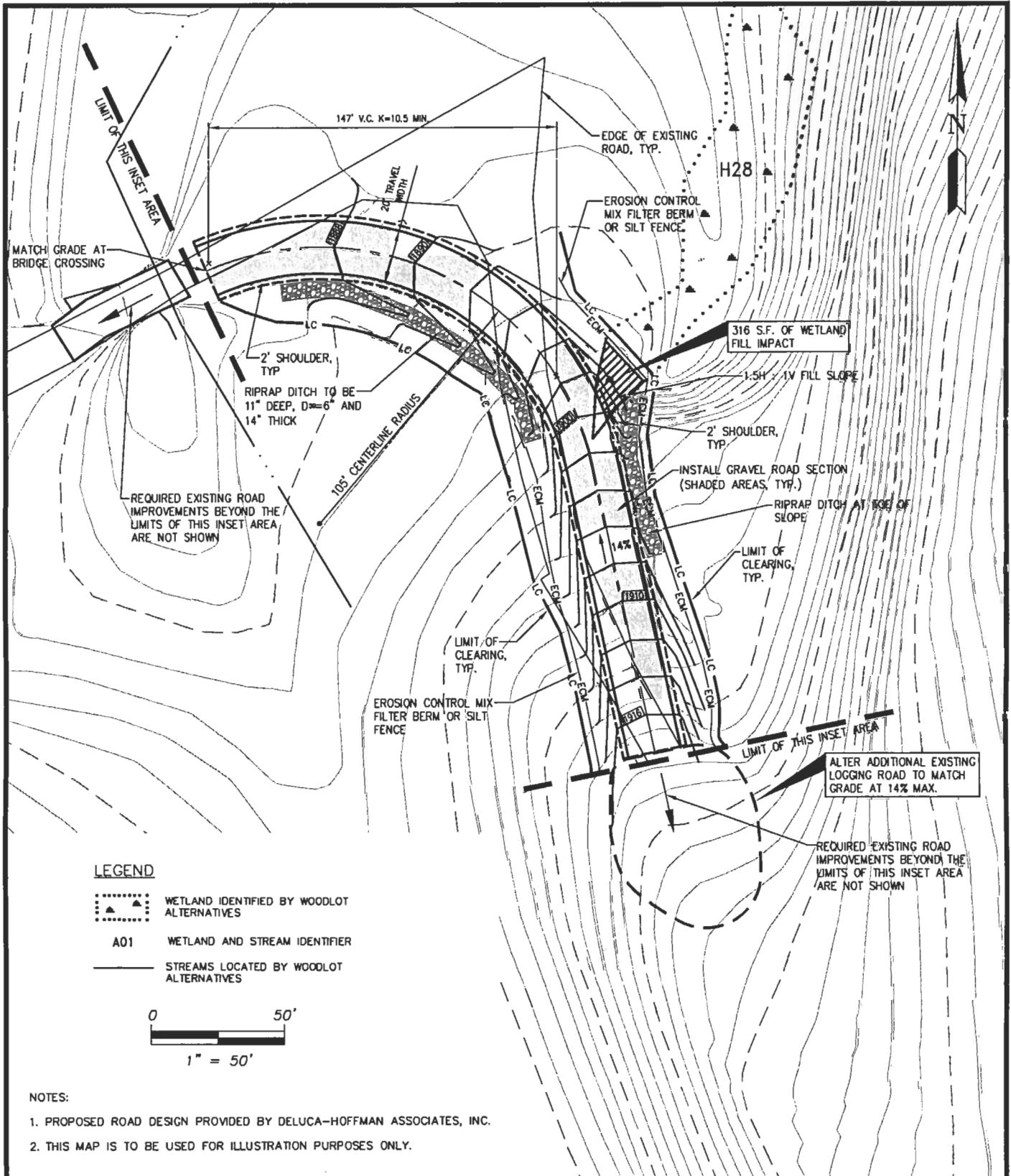

**LEGEND**

- WETLAND IDENTIFIED BY WOODLOT ALTERNATIVES
- A01** WETLAND AND STREAM IDENTIFIER
- STREAMS LOCATED BY WOODLOT ALTERNATIVES

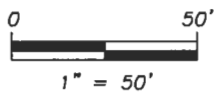

**NOTES:**

1. PROPOSED ROAD DESIGN PROVIDED BY DELUCA-HOFFMAN ASSOCIATES, INC.
2. THIS MAP IS TO BE USED FOR ILLUSTRATION PURPOSES ONLY.

PREPARED BY:

**WOODLOT**  
ALTERNATIVES, INC.  
ENVIRONMENTAL CONSULTANTS

102127-F000-AC0E-impacts.dwg

SHEET TITLE:  
**Inset Area 6A  
Wetland Impacts**

PROJECT:  
**Maine Mountain Power, LLC  
Proposed Redington Wind Farm**

DATE: December 2006

SCALE: 1" = 50'

PROJ. NO.: 102127

FIGURE:  
**3 of 8**

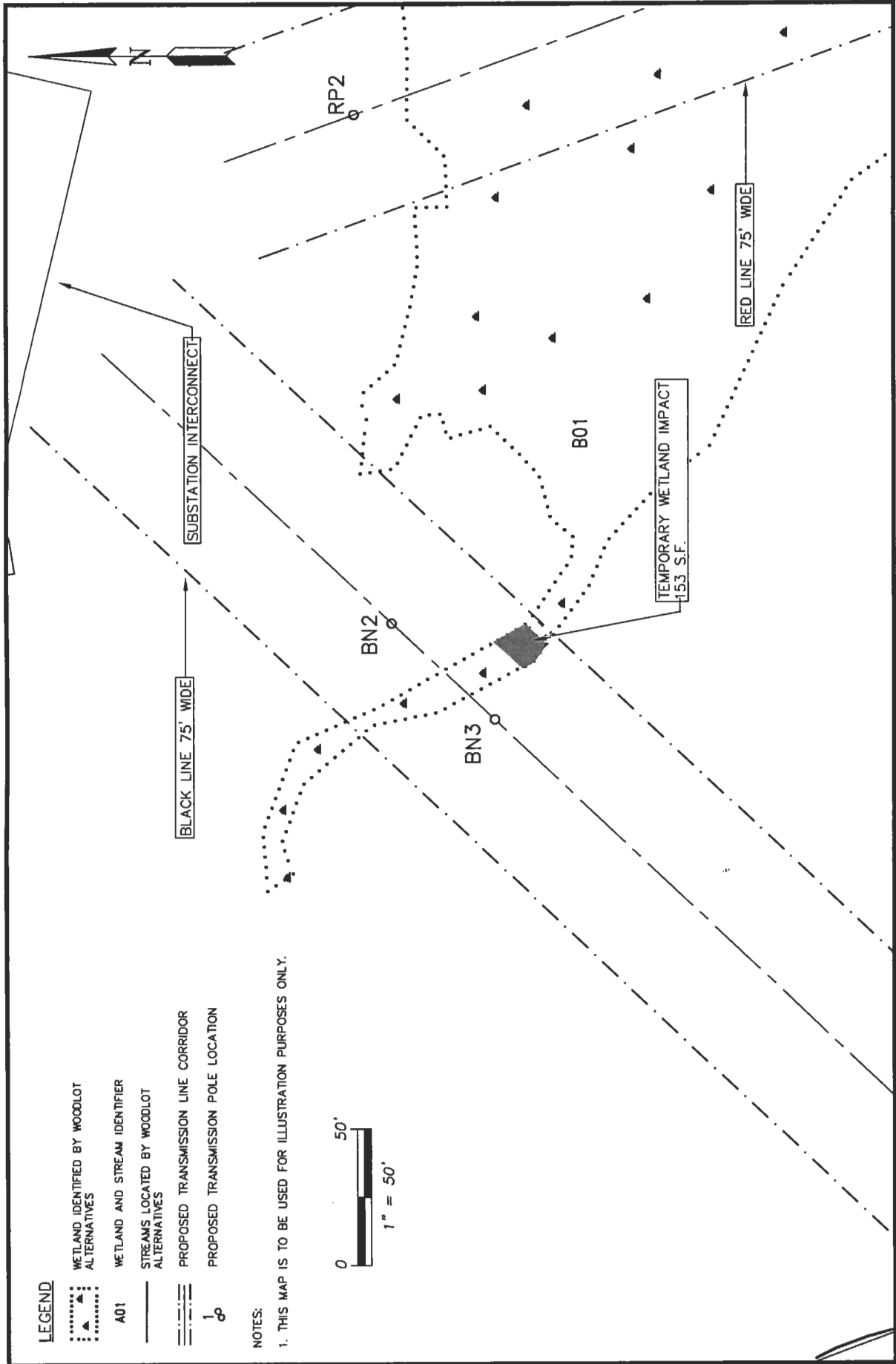

**LEGEND**

WETLAND IDENTIFIED BY WOODLOT ALTERNATIVES

WETLAND AND STREAM IDENTIFIER  
A01

STREAMS LOCATED BY WOODLOT ALTERNATIVES

PROPOSED TRANSMISSION LINE CORRIDOR

PROPOSED TRANSMISSION POLE LOCATION

**NOTES:**

1. THIS MAP IS TO BE USED FOR ILLUSTRATION PURPOSES ONLY.

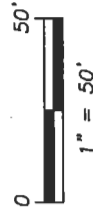

SHEET TITLE:  
**Temporary Impacts  
Wetland B01**

PROJECT:  
Maine Mountain Power, LLC  
Proposed Redington Wind Farm

DESIGN:	DATE: December 2006
DRAFT:	PROJ. NO.: 102127
CHECKED:	SCALE: 1" = 50'
FILE: 102127-F000-ACOE-impacts.dwg	

PREPARED BY:

**WOODLOT**  
ALTERNATIVES, INC.  
ENVIRONMENTAL CONSULTANTS

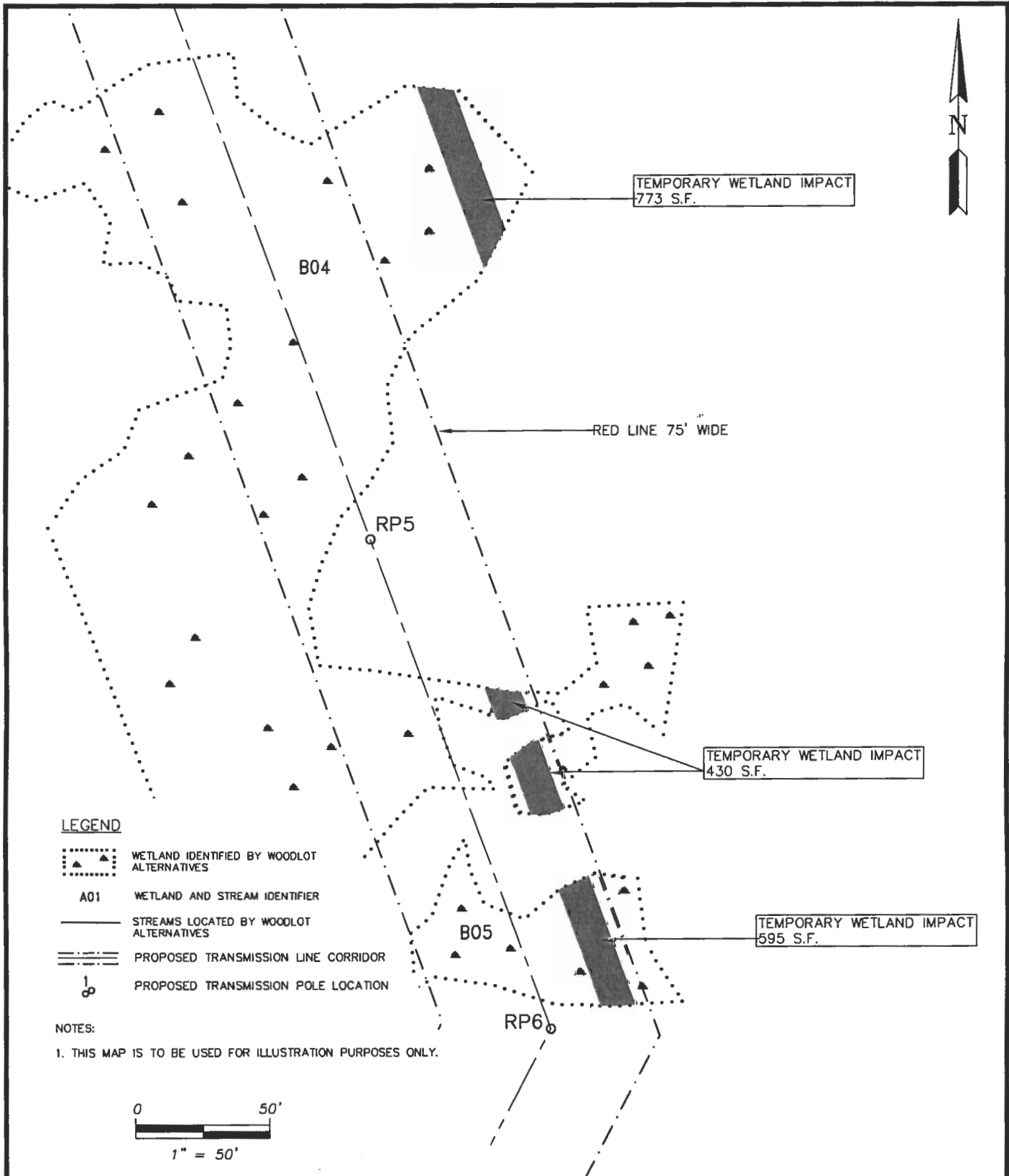

**LEGEND**

- WETLAND IDENTIFIED BY WOODLOT ALTERNATIVES
- A01** WETLAND AND STREAM IDENTIFIER
- STREAMS LOCATED BY WOODLOT ALTERNATIVES
- PROPOSED TRANSMISSION LINE CORRIDOR
- PROPOSED TRANSMISSION POLE LOCATION

NOTES:  
1. THIS MAP IS TO BE USED FOR ILLUSTRATION PURPOSES ONLY.

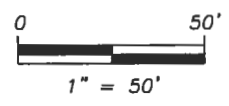

PREPARED BY:

**WOODLOT**  
ALTERNATIVES, INC.  
ENVIRONMENTAL CONSULTANTS

102127-F000-ACDE-impacts.dwg

SHEET TITLE:  
**Temporary Impacts  
Wetlands B04 & B05**

PROJECT:  
Maine Mountain Power, LLC  
Proposed Redington Wind Farm

DATE: December 2006

SCALE: 1" = 50'

PROJ. NO.: 102127

FIGURE:  
**5 of 8**



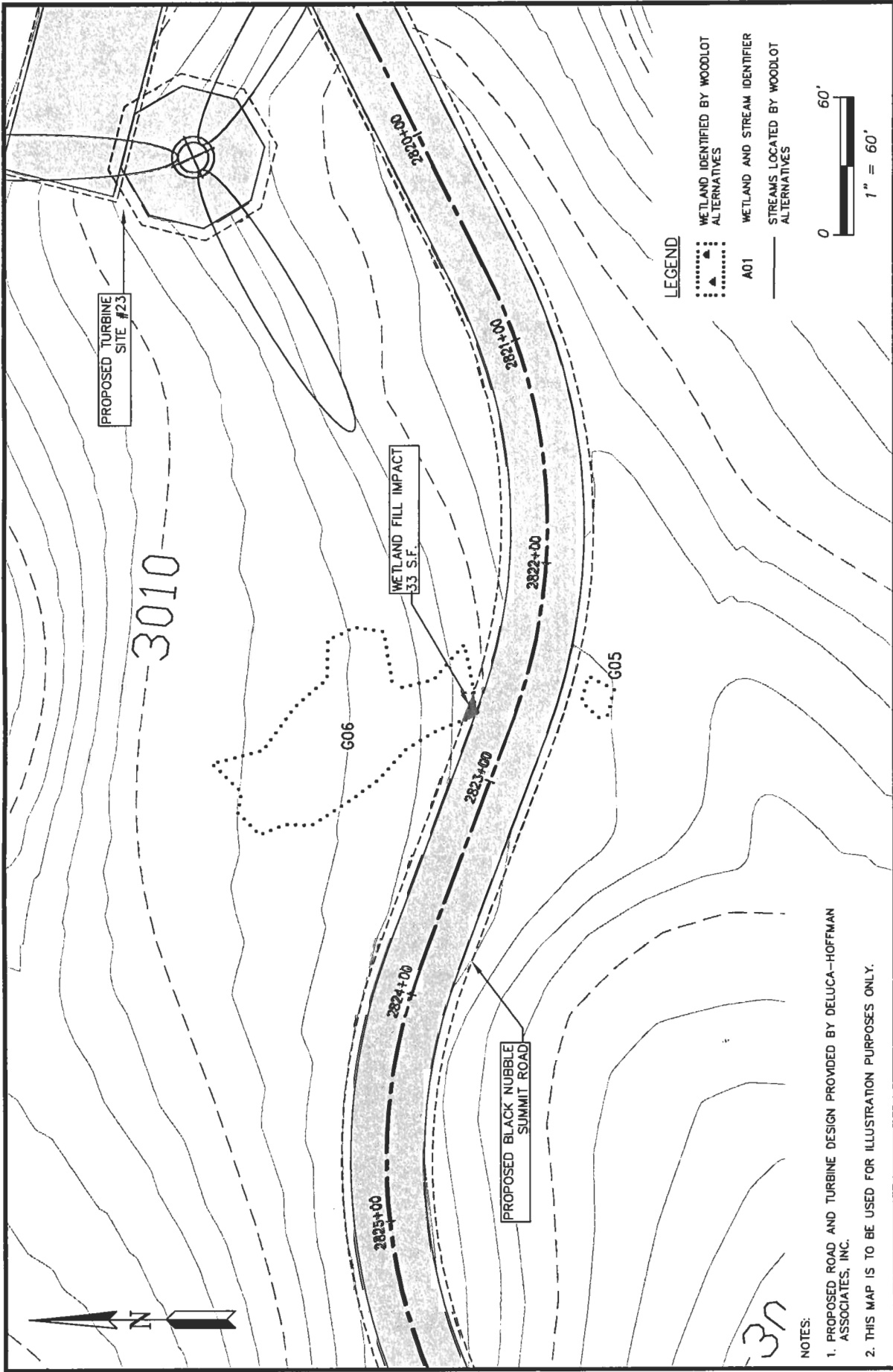

**LEGEND**

- ..... WETLAND IDENTIFIED BY WOODLOT ALTERNATIVES
- ▲ WETLAND AND STREAM IDENTIFIER
- STREAMS LOCATED BY WOODLOT ALTERNATIVES

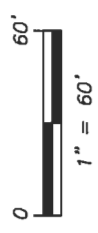

**NOTES:**

1. PROPOSED ROAD AND TURBINE DESIGN PROVIDED BY DELUCA-HOFFMAN ASSOCIATES, INC.
2. THIS MAP IS TO BE USED FOR ILLUSTRATION PURPOSES ONLY.

<p>PREPARED BY:</p>	<p><b>Wetland Fill Impacts</b> <b>Wetland G06</b></p> <p>Maine Mountain Power, LLC Proposed Redington Wind Farm</p>	<p>FIGURE: <b>6 of 8</b></p>
<p>SHEET TITLE:</p>		
<p>DESIGN:</p>	<p>DATE: December 2006</p>	
<p>DRAFT:</p>	<p>PROJ. NO.: 102127</p>	
<p>CHECKED:</p>	<p>SCALE: 1" = 60'</p>	
<p>FILE: 102127-F000-ACOE-impacts.dwg</p>		

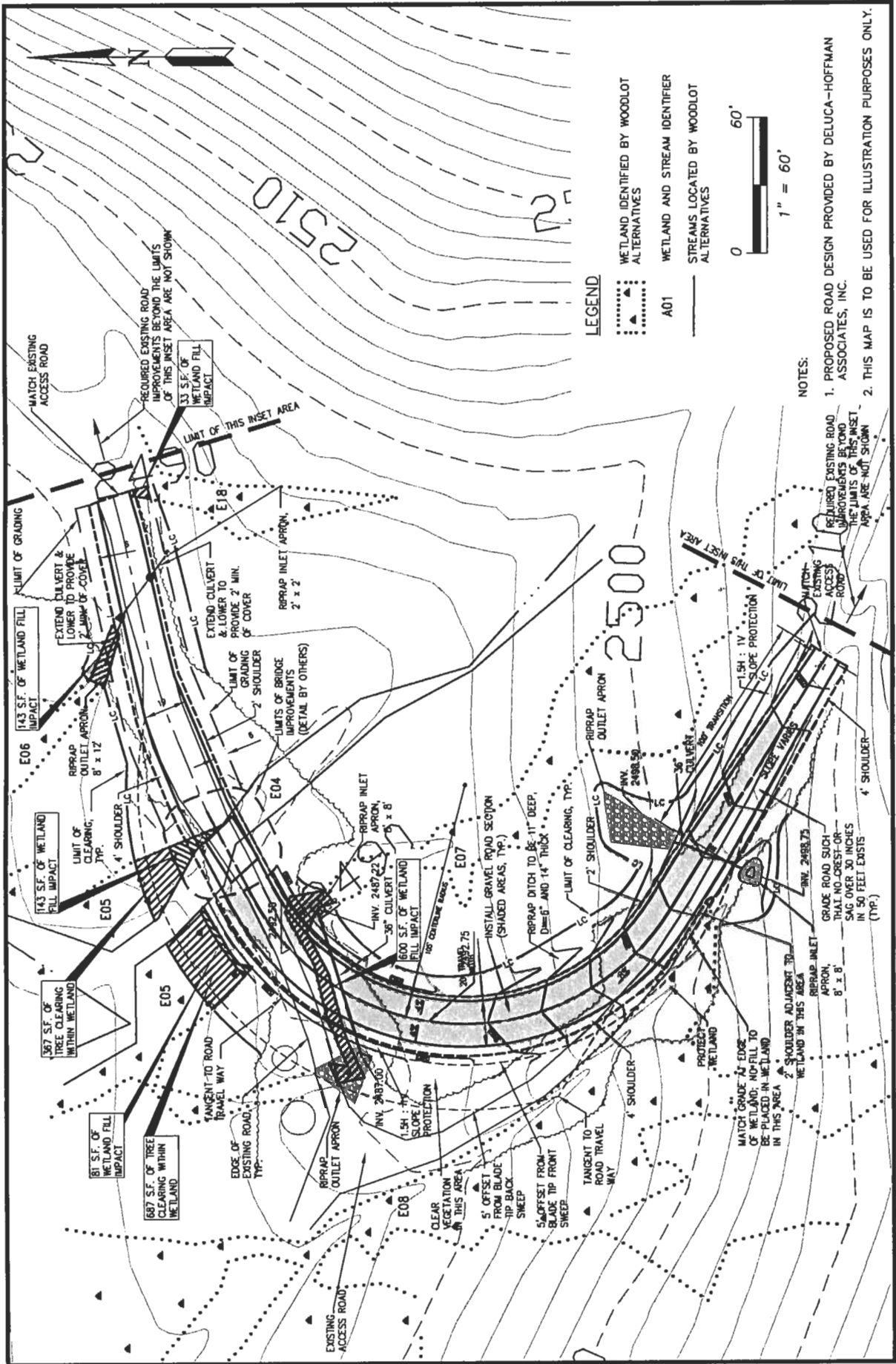

**LEGEND**

- .....▲ WETLAND IDENTIFIED BY WOODLOT ALTERNATIVES
- .....▲ WETLAND AND STREAM IDENTIFIER
- ▲ STREAMS LOCATED BY WOODLOT ALTERNATIVES

A01

0 60'  
1" = 60'

**NOTES:**

1. PROPOSED ROAD DESIGN PROVIDED BY DELUCA-HOFFMAN ASSOCIATES, INC.
2. THIS MAP IS TO BE USED FOR ILLUSTRATION PURPOSES ONLY.

<b>Inset Area #5 Wetland Fill Impacts</b>	
Maine Mountain Power, LLC Proposed Redington Wind Farm	
DESIGN: DATE: December 2006	FIGURE: 7 of 8
DRAFT: PROJ. NO.: 102127	
CHECKED: SCALE: 1" = 60'	
FILE: 102127-F000-ACOE-impacts.dwg	



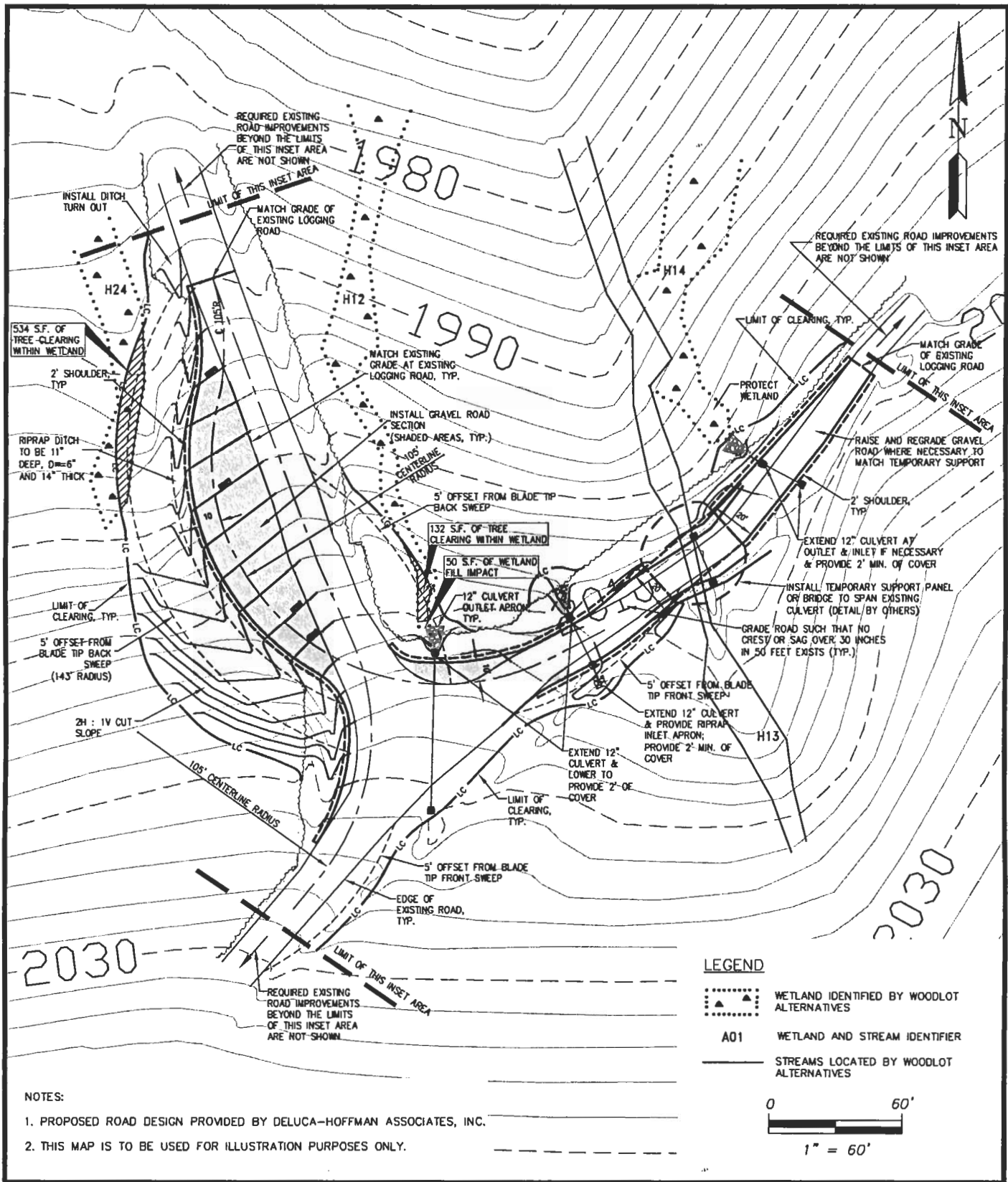

**LEGEND**

- WETLAND IDENTIFIED BY WOODLOT ALTERNATIVES
- A01** WETLAND AND STREAM IDENTIFIER
- STREAMS LOCATED BY WOODLOT ALTERNATIVES

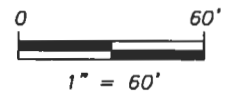

**NOTES:**

1. PROPOSED ROAD DESIGN PROVIDED BY DELUCA-HOFFMAN ASSOCIATES, INC.
2. THIS MAP IS TO BE USED FOR ILLUSTRATION PURPOSES ONLY.

PREPARED BY:

**WOODLOT**  
ALTERNATIVES, INC.  
ENVIRONMENTAL CONSULTANTS

102127-F000-ACOE-impacts.dwg

SHEET TITLE:  
**Inset Area #3  
Wetland Fill Impacts**

PROJECT:  
**Maine Mountain Power, LLC  
Proposed Redington Wind Farm**

DATE: December 2006

SCALE: 1" = 60'

PROJ. NO.: 102127

FIGURE:  
**8 of 8**



**US Army Corps  
of Engineers** ®  
New England District

(Minimum Notice: Permittee must sign and return notification  
within one month of the completion of work.)

## COMPLIANCE CERTIFICATION FORM

USACE Project Number: \_\_\_\_\_

Name of Permittee: \_\_\_\_\_

Permit Issuance Date: \_\_\_\_\_

Please sign this certification and return it to the following address upon completion of the activity and any mitigation required by the permit. You must submit this after the mitigation is complete, but not the mitigation monitoring, which requires separate submittals.

\*\*\*\*\*  
 \* MAIL TO: U.S. Army Corps of Engineers, New England District \*  
 \* Policy Analysis/Technical Support Branch, ATTN: Marie Farese \*  
 \* Regulatory Division \*  
 \* 696 Virginia Road \*  
 \* Concord, Massachusetts 01742-2751 \*  
 \*\*\*\*\*

Please note that your permitted activity is subject to a compliance inspection by an U.S. Army Corps of Engineers representative. If you fail to comply with this permit you are subject to permit suspension, modification, or revocation.

**I hereby certify that the work authorized by the above referenced permit was completed in accordance with the terms and conditions of the above referenced permit, and any required mitigation was completed in accordance with the permit conditions.**

\_\_\_\_\_  
Signature of Permittee

\_\_\_\_\_  
Date

\_\_\_\_\_  
Printed Name

\_\_\_\_\_  
Date of Work Completion

Telephone Number ( ) \_\_\_\_\_



US Army Corps  
of Engineers  
New England District

**PGP WORK START NOTIFICATION FORM**  
**(Minimum Advance Notice: Two Weeks)**

**MAIL TO:** U.S. Army Corps of Engineers, New England District  
Regulatory Branch  
Policy Analysis/Technical Support Section  
696 Virginia Road  
Concord, Massachusetts 01742-2751

A Corps of Engineers Permit (No \_\_\_\_\_) was issued to \_\_\_\_\_. The permit authorized the permittee(s) to \_\_\_\_\_  
\_\_\_\_\_  
\_\_\_\_\_

The people (e.g., contractor) listed below will do the work, and they understand the permit's conditions and limitations.

PLEASE PRINT OR TYPE

Name of Person/Firm: \_\_\_\_\_  
\_\_\_\_\_  
\_\_\_\_\_

Business Address: \_\_\_\_\_  
\_\_\_\_\_  
\_\_\_\_\_

Telephone: ( ) \_\_\_\_\_ ( ) \_\_\_\_\_

Proposed Work Dates: Start: \_\_\_\_\_  
Finish: \_\_\_\_\_

PERMITTEE'S SIGNATURE: \_\_\_\_\_ DATE: \_\_\_\_\_

PRINTED NAME: \_\_\_\_\_ TITLE: \_\_\_\_\_

**FOR USE BY THE CORPS OF ENGINEERS**

PM \_\_\_\_\_ Submittals Required: \_\_\_\_\_

Inspection Recommendation: \_\_\_\_\_